

## Use Hunter Xci 286 — More ci Installation Options When Left Exposed

**HUNTER Xci 286 IS TWO-SIDED, REFLECTIVE FOIL AND WHITE FOIL TO MEET YOUR DESIGN CRITERIA**

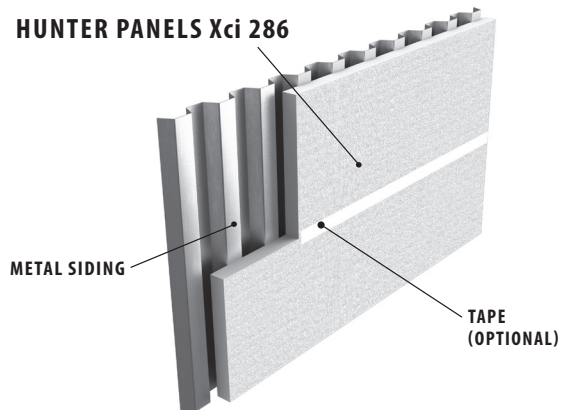

**HUNTER Xci 286 FOR EXPOSED CEILING OR WALL APPLICATIONS**

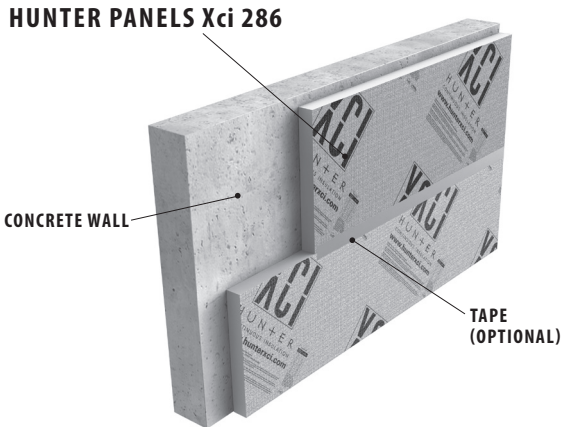
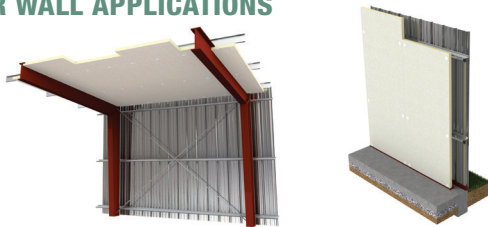

**Samples and literature available  
at [www.hunterpanels.com](http://www.hunterpanels.com)**

Hunter Panels • 15 Franklin St, Portland, Maine 04101  
888.746.1114 • Fax 877.775.1769 • [www.hunterpanels.com](http://www.hunterpanels.com)

### THE PRODUCT:

- May be left exposed on the interior of buildings with no additional thermal barrier required
- Aesthetic exposure options
  - Either side of the product is approved to be left exposed, reflective foil or white foil
  - Matching white foil tape available for joint treatment
- Potential for added R-value if reflective foil face is installed toward the wall cavity per ASHRAE Fundamental Handbook
- Polyiso foam core – high R-value in thin profile
- Available Grade 2 (20 psi) or Grade 3 (25 psi)
- Available in 4' x 8' or custom sizes, from 1"– 3.5" with R-values from 6.3–22.0
- Pressure washable 15 mil facer

### APPLICATIONS:

- Provides exposed interior continuous insulation in commercial and residential applications such as: metal buildings, attic knee walls and floors, crawl spaces, parking garages, basements, industrial and agricultural buildings.

### THE APPROVALS:

- NFPA 286 passed for exposed interior ceiling or wall applications
- Facilitates compliance with the most current ASHRAE 90.1, IECC, IBC and IRC standards
- ASTM D1037 for Impact Resistance Test – passed
- Provides exterior sheathing options in tested NFPA 285 wall assemblies. Contact Hunter Xci for details.

### SALES BENEFITS:

- Reduced stocking inventory – one product serves multiple functions resulting in fewer SKU's
- Single Source Responsibility – trucks can be filled with other Xci polyiso products
- Multiple Manufacturing Facilities



HUNTER  
CONTINUOUS INSULATION